

QUICKSTART

KM 120/150 R Bp/Bp Pack



Warning

These are only brief instructions! Please read and comply with these instructions prior to using or servicing your appliance.

The non-compliance of the operating and safety instructions may lead to damages of the appliance and to dangers for the operator and other persons.

Start up

1



Bp model

- A Open the device hood.
- B Switch off the charger and remove the plug from the socket.
Pull the battery cable from the charger cable and connect it to the appliance.
- C Close cover.



Bp Pack model

- A Open the device hood.
- B Unplug the charger from the mains.
Place the mains cable into the storage compartment.
- C Close cover.

2



- A Pull seat adjustment lever outwards.
- B Move seat, release lever and lock in place.
Check that the seat is properly locked in position by attempting to move it backwards and forwards.
- C Adjust the seat back.
- D Position the steering wheel.



Operation

1

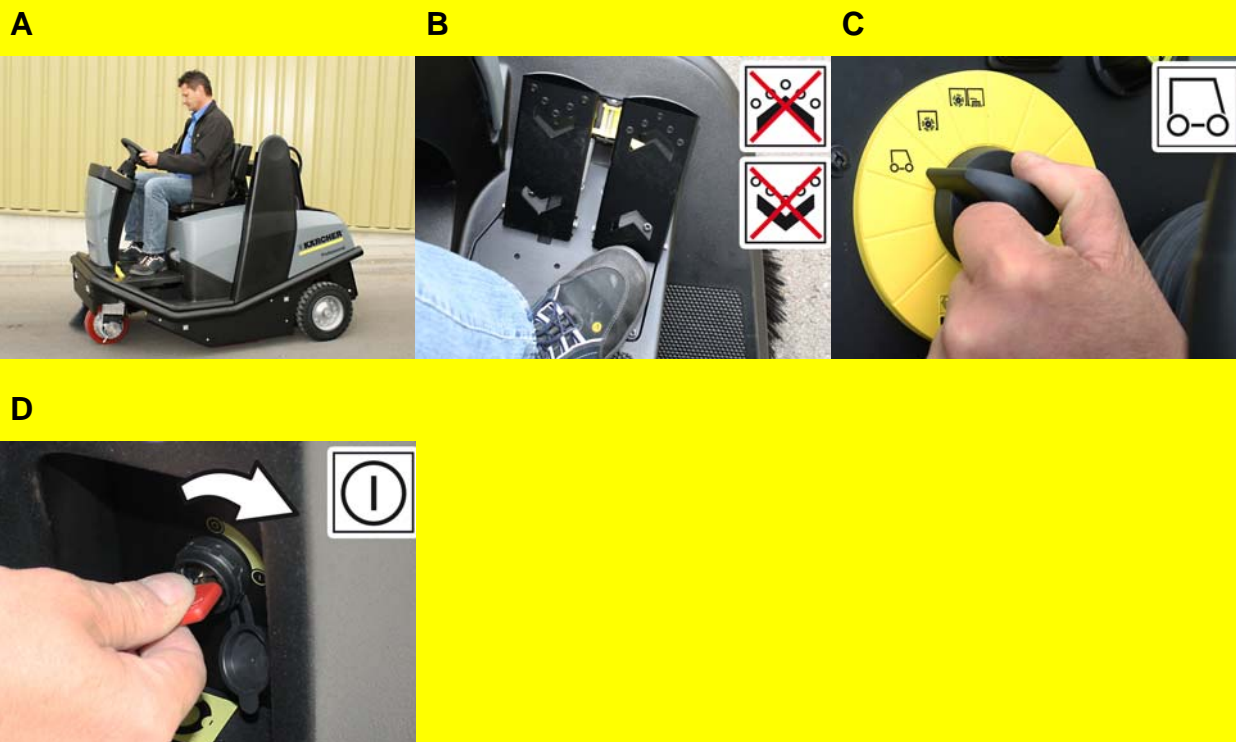

Starting the machine

- A Sit on the driver's seat.
- B Do NOT press the accelerator pedal.
- C Set programme switch to stage 1 (driving).
- D Turn key switch to position "I".

2



Drive the machine

- A Press slowly the accelerator pedal "forward".
- B Press slowly the accelerator pedal "reverse".
- C Release the accelerator pedal, the machine brakes automatically and stops.

3

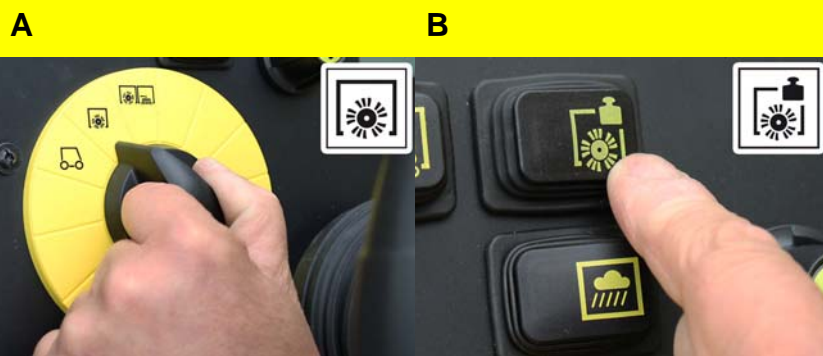

Sweeping with sweep roller

- A Set programme switch to stage 2. Roller brush is lowered.

Increase roller brush pressure

- B Press power button. Indicator lamp is illuminated.

4



Sweeping with side brushes

- A Set programme switch to stage 3. The side brushes and roller brush are lowered.

5



Sweeping with raised coarse waste flap

- A Push the coarse waste flap pedal towards the front and hold it there briefly. To lower it, take foot off pedal.

Operation

6



Sweeping damp or wet floors

A Fan "Off".

7



Cleaning the dust filter

- A Fan "Off".
- B Depending on the amount of the collected dust, the dust filter must be cleaned during operation.
- C Fan "On".

8



Operation with working lights

A Switch on the working light.

9

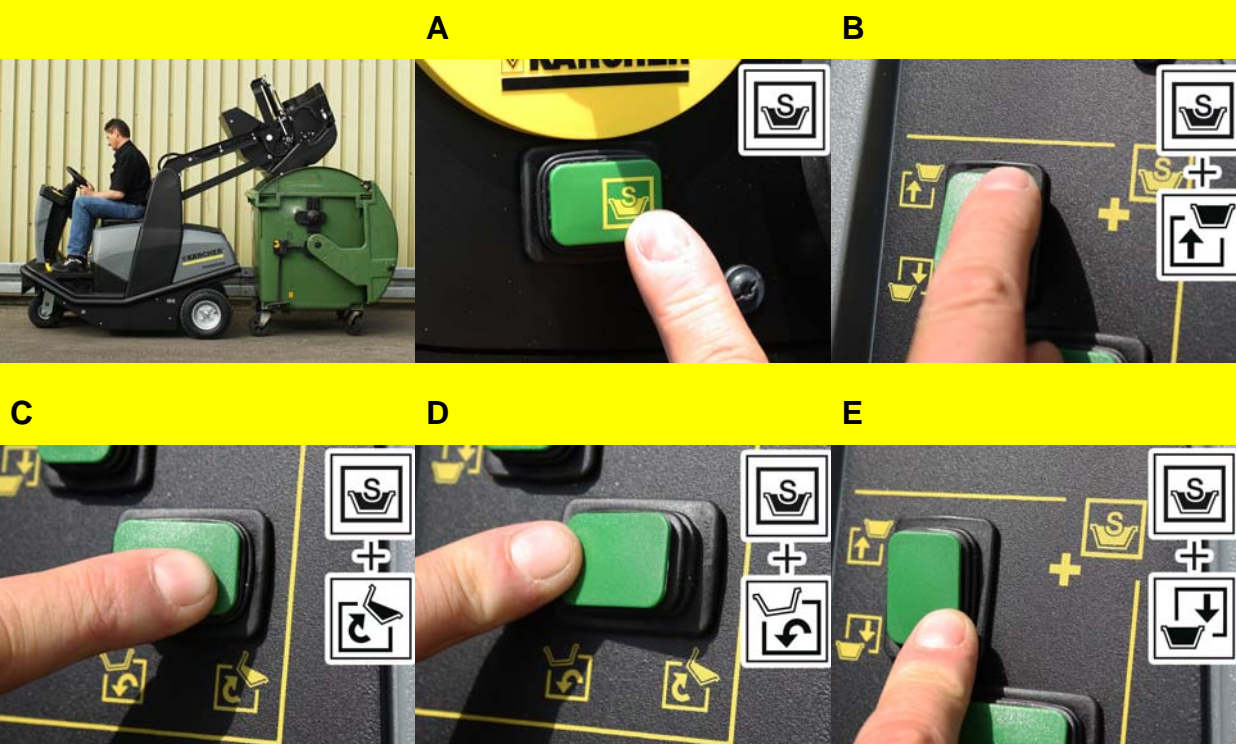

Emptying waste container

⚠ **Danger**

Risk of injury! When emptying the waste container, care should be taken to ensure that no persons or animals are within its swivelling range.

⚠ **Danger**

Danger of crushing. Never reach into the rod assembly for the drainage mechanism. Stay away from the area under the raised container.

⚠ **Danger**

Danger of tipping! Place the appliance on an even surface during the emptying process.

- A Keep the switch for the two-handed operations lift/tilt emptying mechanism pressed.
- B Raise waste container.
- C Tip waste container out.
- D Tilt the waste container up to the end-position.
- E Lower waste container.

Finish operation

1



Emptying waste container
See "Operation"

2

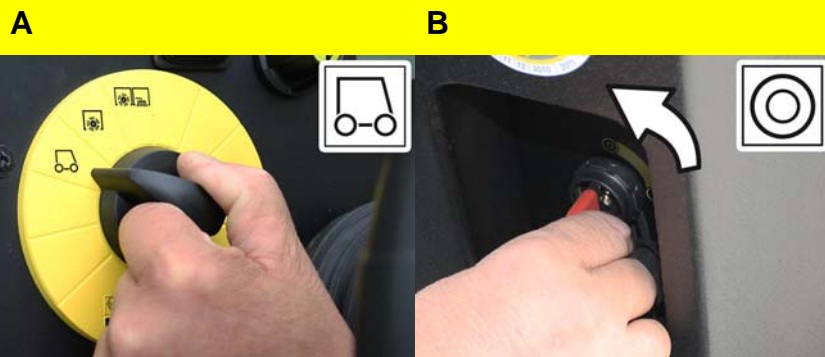

Turn off the appliance

- A Set programme switch to stage 1 (driving). The side brushes and roller brush are raised.
- B Turn ignition key to "0" and remove it.

Maintenance and care

daily

weekly

Kärcher Customer Service

1



- A Check the sweeping roller and the side brush for wear and wrapped belts.

2



- A Check dust filter and clean filter box, if required.
 - B Clean the machine with a damp cloth which has been soaked in mild detergent.
- ⚠ Warning**
Risk of damage! Do not wash down the appliance with water and do not use aggressive detergents.

Troubleshooting

1

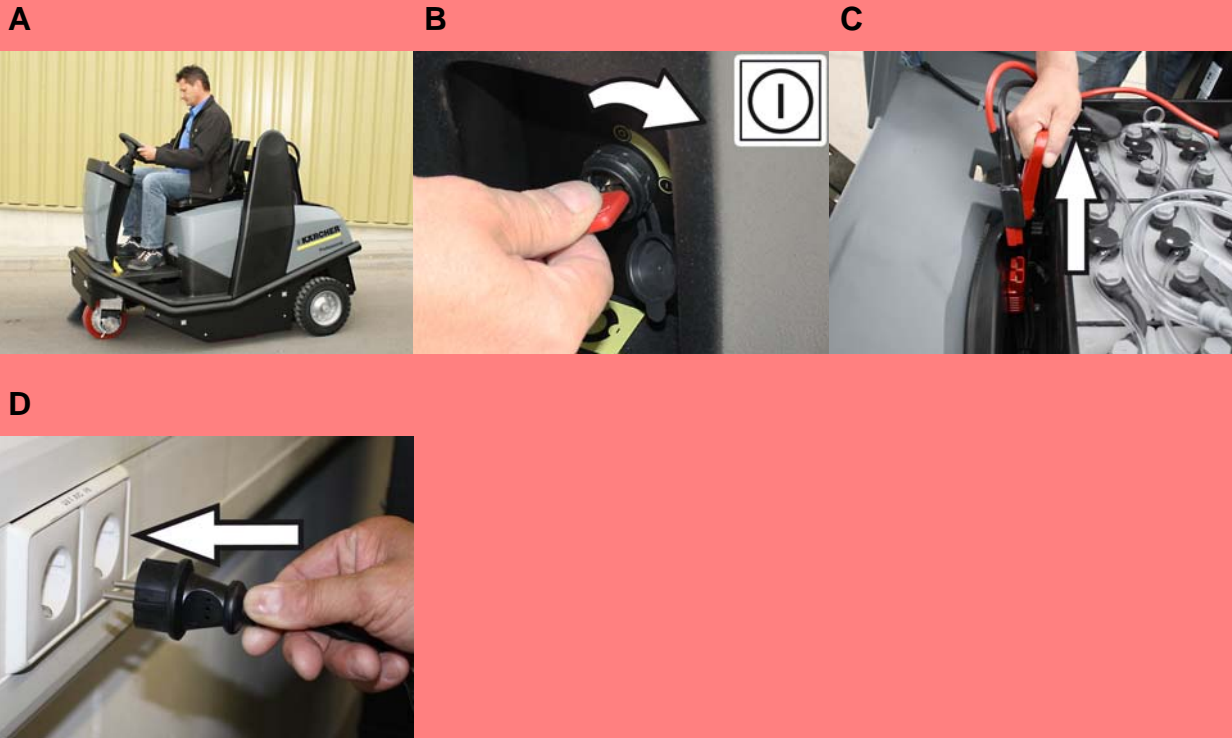

Appliance cannot be started

- A Sit on the driver seat, the seat contact switch gets activated
- B Turn key switch to position "I".
- C **Bp model**
Remove battery plug and join it to the charging cable.
Switching on the charger
- D **Bp Pack model**
Remove the mains cable from the storage bin.
Connect the charger to the mains and turn it on.

2



Engine is running but machine is not moving

- A Check setting of freewheel lever

3



Machine is not sweeping properly

- A Check roller brush and side brushes for wear, replace if necessary.
- B Adjust sweeping track
- C Check function of bulk waste flap

4

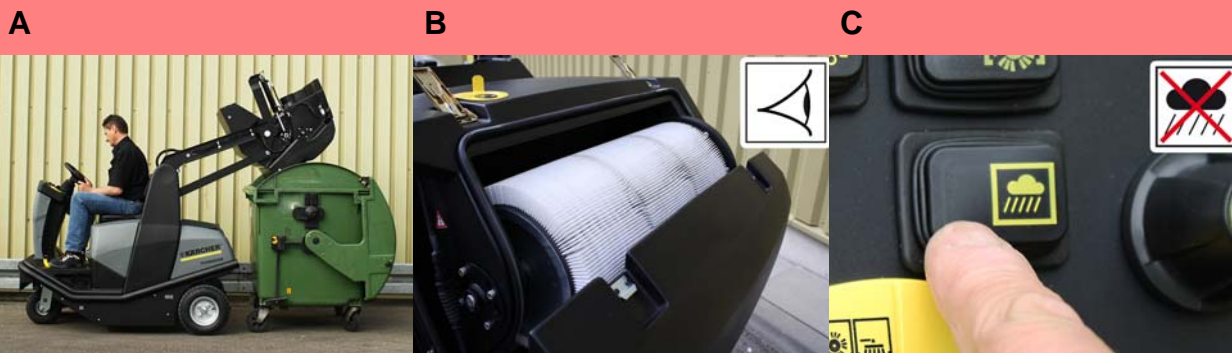

Dust gathers in the machine

- A Empty waste container
See "Operation"
 - B Check, clean or replace dust filter
 - C Close wet/dry flap
- Roller brush does not turn.
- A Remove tapes or cords from the roller brush